

ENARC CONSULTANTS
ARCHITECTS AND ENGINEERS
 M. G. Road, Thrissur - 1.
 Tel. : +91 (487) 2441901
 Fax : +91 (487) 2442011
 E-mail : office@enarc.net.in

**PROPOSED INTERIOR FURNISHING FOR
 UNITED INDIA INSURANCE
 CORPORATION, NENMARA**

**LAYOUT PLAN
 OPTION 1**

LEGEND

- PARTLY GLAZED FULL HEIGHT PARTITION 7' HT
- FULLY BLOCKED DOUBLE SKIN PARTITIONS
- PARTLY GLAZED LOW HT PARTITION 3'6" HT
- DOUBLE SKIN GLAZED PARTITIONS

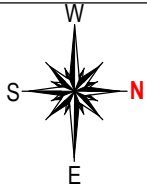

Drawn By
 Architect
 Structural Consultant

DISMI DAVIS
 PRAVEEN.P
 B. Arch.[Reg], A.I.I.A, A.I.I.I.D

Dr. R.P.R. NAIR M.Tech.(Stru)
 Ph.D., F.I.E., M.ISTE, M.ICI,
 M.CSI, C. Eng.(I).

Chief Architect
 K. RAMAKRISHNAN
 B.Sc.(Engg), M.I.E, C. Eng (I),
 F.I.V.A.I.I.A.(Regd.)

Date: 05-06-2017
 Revision Dates:
 28-07-2017
 26-08-2017

Sheet No :01
 Drawing No:
 Scale: Not to scale

All Dimensions are in CMs.

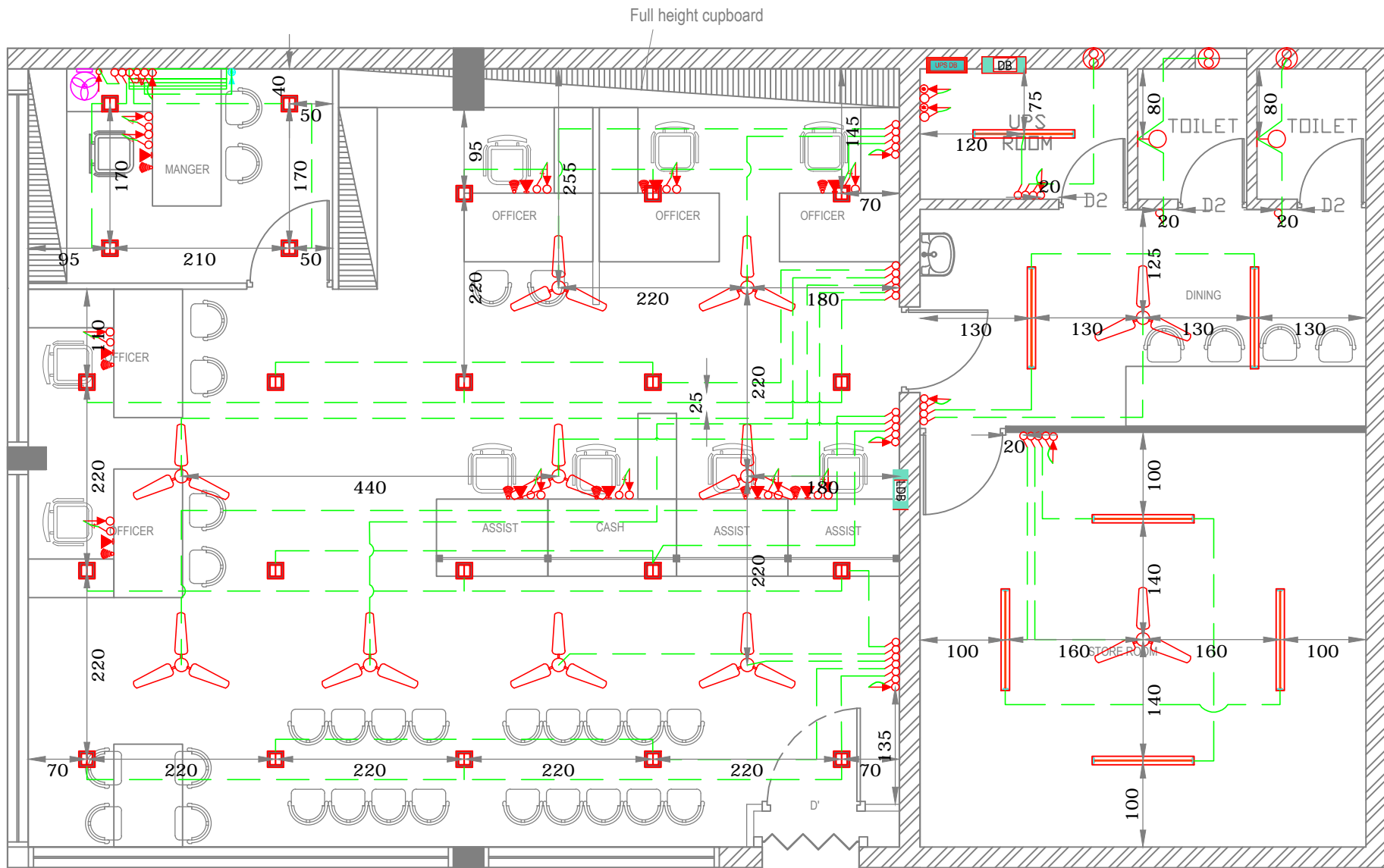

ENARC CONSULTANTS
ARCHITECTS AND ENGINEERS
 M. G. Road, Thrissur - 1.
 Tel. : +91 (487) 2441901
 Fax : +91 (487) 2442011
 E-mail : office@enarc.net.in

**PROPOSED INTERIOR FURNISHING FOR
 UNITED INDIA INSURANCE
 CORPORATION, NENMARA**

LAYOUT PLAN

LEGEND		Nos
	LED Square light	22
	Wall fan	1
	Bracket light	2
	Ceiling fan	11
	Telephone	10

LEGEND		Nos
	UPS plug points - 4 outlets	11
	6A Socket	7
	16A Socket	2
	20 A Socket	1
	Fluorescent Lamp	7
	Exhaust fan	3

LEGEND		Nos
	AC Indoor	1
	AC outdoor	1
	Distribution board	1
	LDB	1
	UPS DB	1

Drawn By	DISMI DAVIS	Chief Architect
Architect		
	PRAVEEN.P B. Arch,[Reg], A.I.I.A, A.I.I.I.D	

	Ar. K. RAMAKRISHNAN B.Sc.(Engg), F.I.E, C. Eng (I), F.I.V, F.I.I.A. (Regd), A.I.I.I.D

Date: 17-10-2017	Sheet No :01
Revision Dates:	Drawing No:
	Scale: Not to scale

All Dimensions are in CMs.



ENARC CONSULTANTS
ARCHITECTS & ENGINEERS
 M. G. Road, Thrissur - 1.
 Tel. : (+91 487) 2441901
 Fax : (+91 487) 2442011
 E-mail : office@enarc.net.in

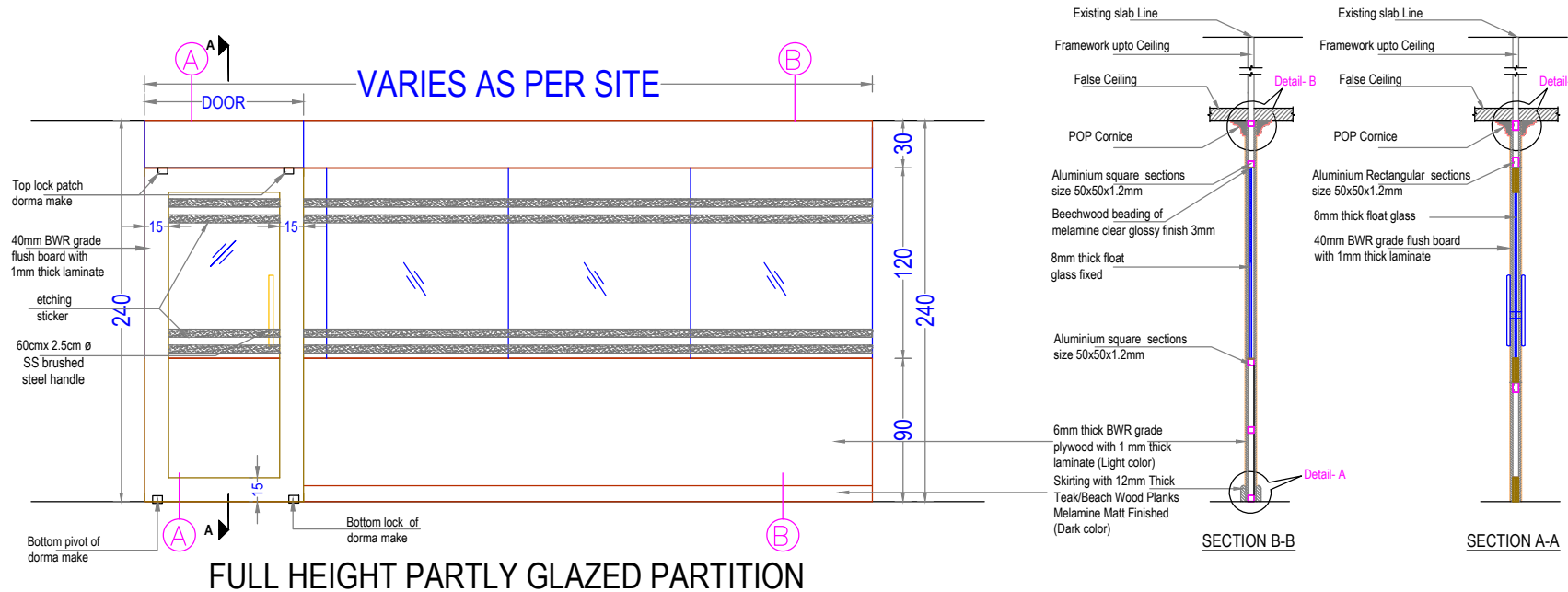

FULL HEIGHT PARTLY GLAZED PARTITION

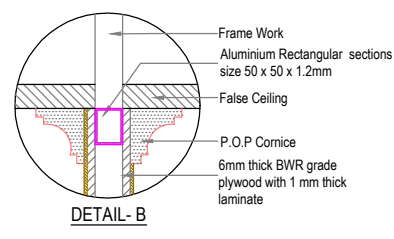
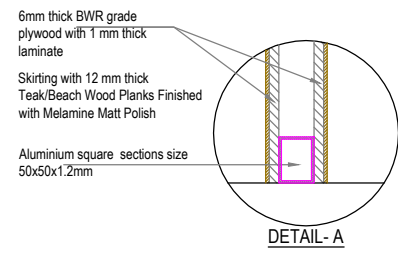

**PROPOSED INTERIOR FURNISHING
 FOR UNITED INDIA INSURANCE
 CORPORATION - NENMARA**

DETAILS OF: PARTLY GLAZED FULL HEIGHT PARTITION FULLY GLAZED DOOR		ITEM Nos. 1
Drawn by	DISMI DAVIS	
Architect	PRAVEEN.P B. Arch.[Reg], A.I.I.A, A.I.I.I.D	
Structural Consultant	Dr. R. P. R. NAIR, M. Tech.(Stru.) Ph.D., M.I.E, M.I.S.T.E., C.Engr(I)	
Chief Architect	Ar. K. RAMAKRISHNAN B.Sc.(Engg), M.I.E, C. Eng (I), F.I.V, F.I.I.A. (Regd), A.I.I.I.D	
Date:	19-09-2017	Drawing No.
Revision Date:	Sheet No.	02
	Scale	NTS
	All Dimensions are in Cms.	

Aluminium Section

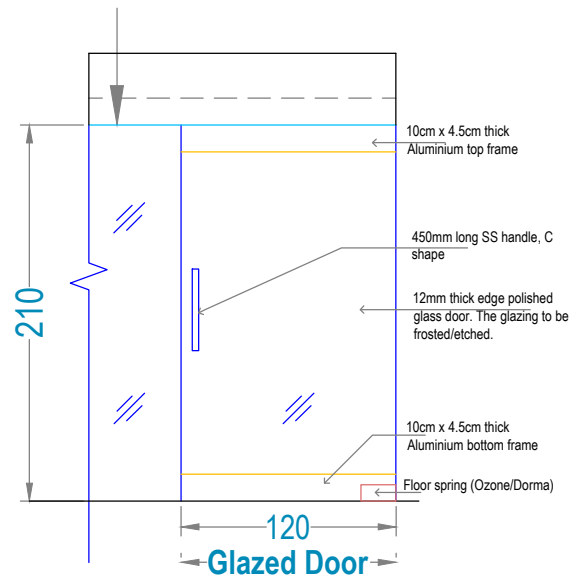

FRONT ELEVATION

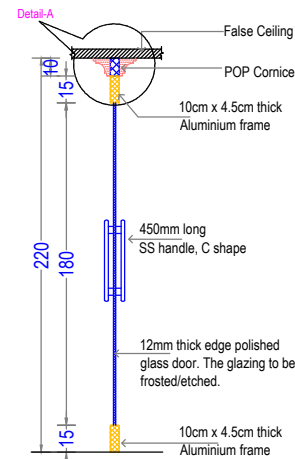

SECTION-AA

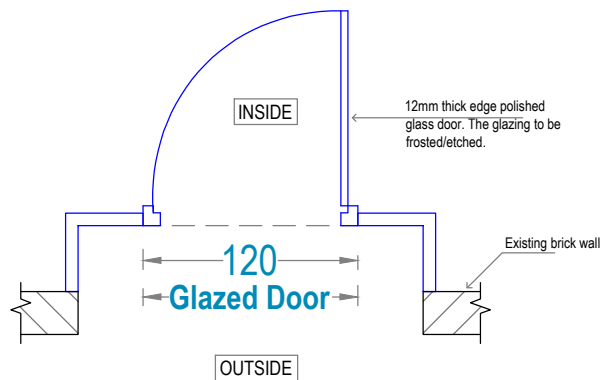

ENTRANCE DOOR PLAN

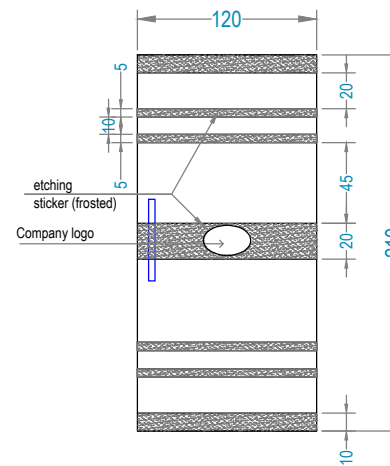

DOOR ETCHING DETAIL

PROPOSED INTERIOR FURNISHING FOR UNITED INDIA INSURANCE CORPORATION - NENMARA

DETAILS OF :	ITEM NOS.
FRONT SIDE GLAZING WITH DOOR	2

Drawn by	DISMI DAVIS
Architect	PRAVEEN.P B. Arch.[Reg], A.I.I.A, A.I.I.I.D
Structural Consultant	Dr. R.P.R. NAIR M.Tech.(Stru) Ph.D., F.I.E., M.ISTE, M.ICI, M.CSI, C. Eng.(I).
Managing Partner	Ar. K. RAMAKRISHNAN B.Sc.(Engg), F.I.E, C. Eng (I), F.I.V, F.I.I.A. (Regd), A.I.I.I.D

Date: 26-05-2017	Drawing No.
Revision Date:	Sheet No. 03
	Scale NTS
All Dimensions are in CMs.	

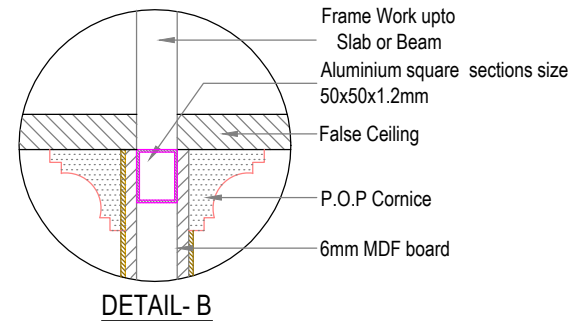
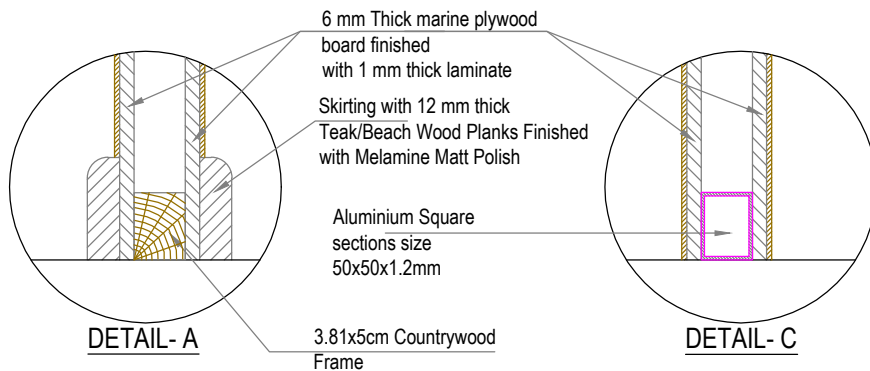
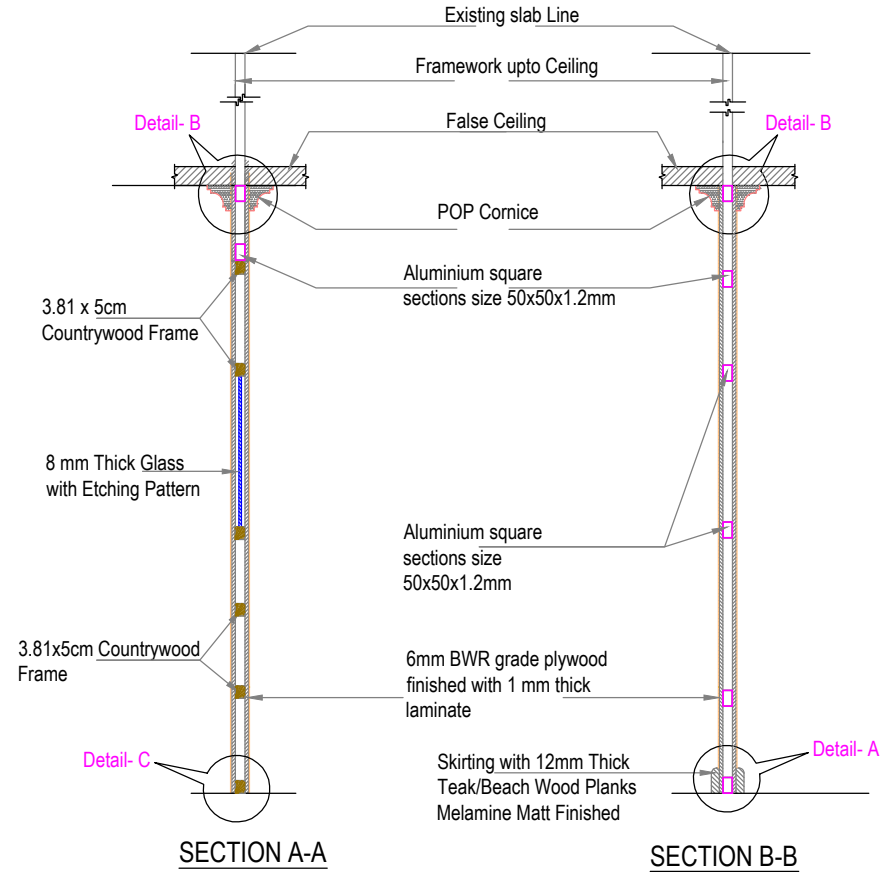
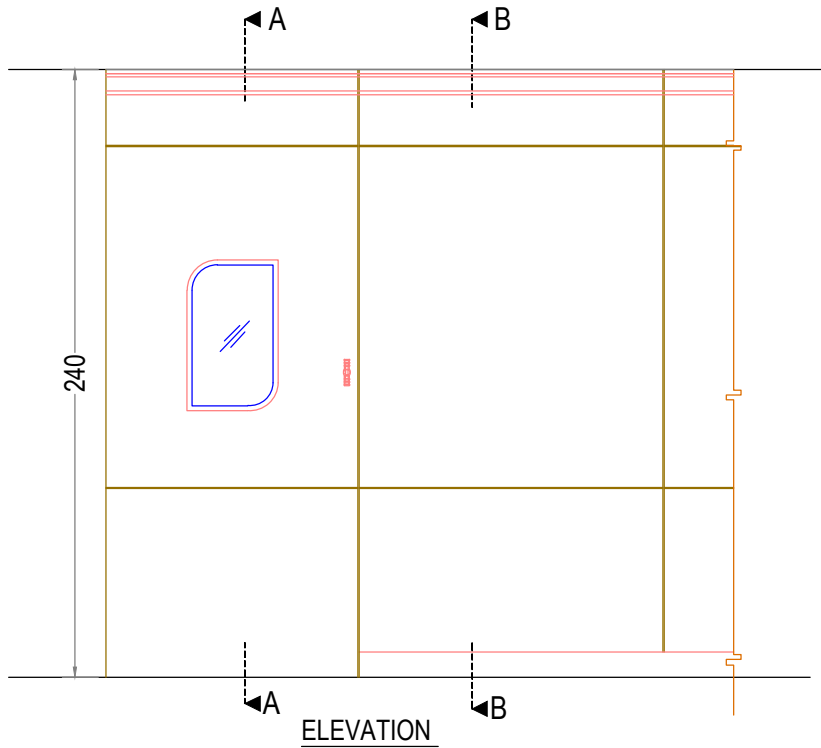

**PROPOSED INTERIOR FURNISHING
FOR UNITED INDIA INSURANCE
CORPORATION - NENMARA**

DETAILS OF :	ITEM NOS.
1. FULLY BLOCKED DOUBLE SKIN PARTITION	
2. DOOR	4a

Drawn by	DISMI DAVIS
Architect	PRAVEEN.P B. Arch,[Regd], A.I.I.A, A.I.I.I.D

Structural Consultant	Dr. R. P. R. NAIR, M. Tech.(Stru.) Ph.D., M.I.E, M.I.S.T.E., C.Eng(I)
-----------------------	--

Chief Architect	Ar. K. RAMAKRISHNAN B.Sc.(Engg), M.I.E, C. Eng (I), F.I.V, F.I.I.A. (Regd), A.I.I.I.D
-----------------	---

Date: 25-09-2017	Drawing No.
Revision Date:	Sheet No: 04
	Scale NTS
All Dimensions are in CMs.	

**PROPOSED INTERIOR
 FURNISHING FOR UNITED
 INDIA INSURANCE
 CORPORATION - NENMARA**

DETAILS OF :	ITEM NOS.
1. MANAGER TABLE 180X90X75	8
2. SIDE TABLE 100X45X72.5	14

Drawn by	DISMI DAVIS
Architect	PRAVEEN.P B. Arch.[Reg], A.I.I.A, A.I.I.I.D
Structural Consultant	Dr. R.P.R. NAIR M.Tech.(Stru) Ph.D., F.I.E., M.ISTE, M.ICI, M.CSI, C. Eng.(I).
Managing Partner	Ar. K. RAMAKRISHNAN B.Sc.(Engg), F.I.E, C. Eng (I), F.I.V , F.I.I.A. (Regd), A.I.I.I.D

Date: 25-09-2017	Drawing No.
Revision Date:	Sheet No. 05
	Scale NTS
All Dimensions are in CMs.	

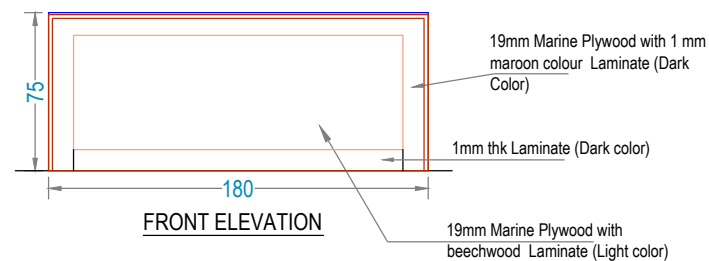
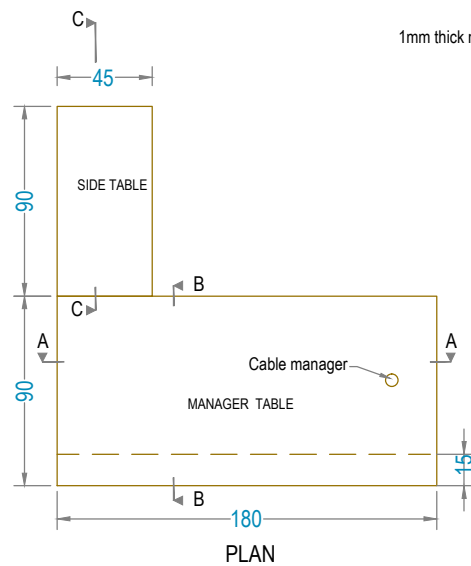
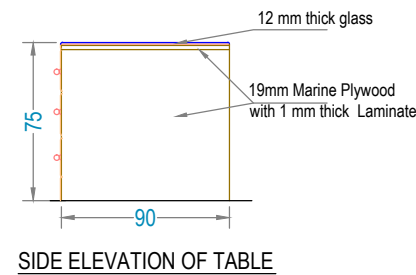
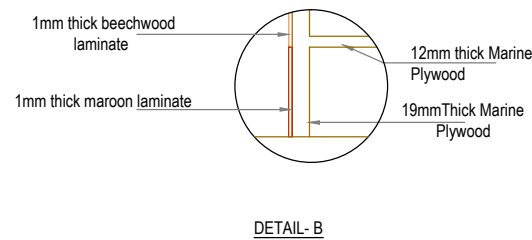
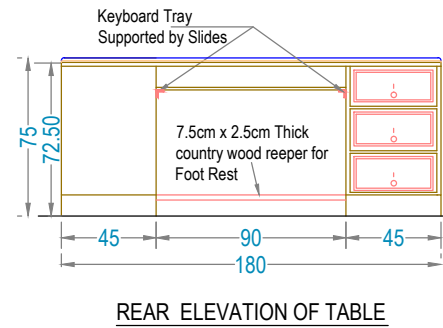
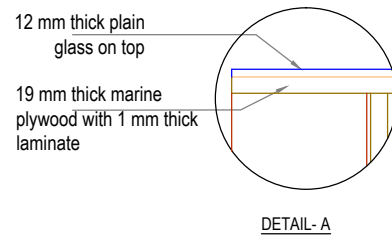
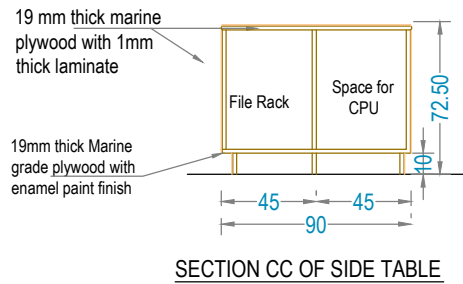
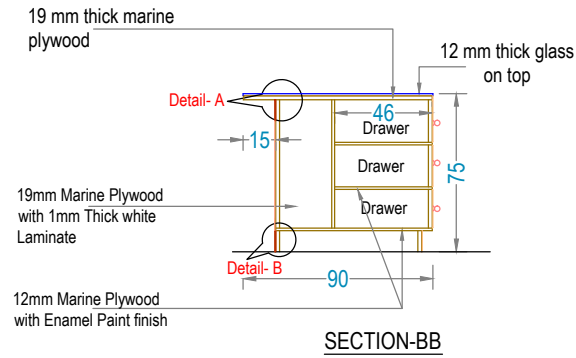
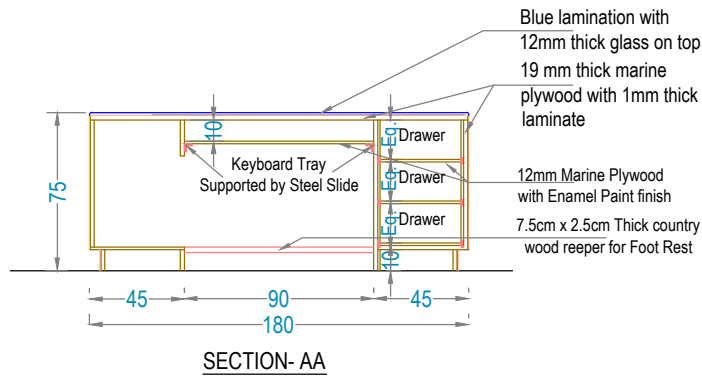

**PROPOSED INTERIOR
 FURNISHING FOR UNITED
 INDIA INSURANCE
 CORPORATION - NENMARA**

DETAILS OF :	ITEM NOS.
1. OFFICER TABLE 150X75X75	09
2. SIDE TABLE 100X45X72.5	14

Drawn by	DISMI DAVIS
Architect	PRAVEEN.P B. Arch.[Reg], A.I.I.A, A.I.I.I.D
Structural Consultant	Dr. R.P.R. NAIR M.Tech.(Stru) Ph.D., F.I.E., M.ISTE, M.I.CI, M.CSI, C. Eng.(I).
Managing Partner	Ar. K. RAMAKRISHNAN B.Sc.(Engg), F.I.E, C. Eng (I), F.I.V , F.I.I.A. (Regd), A.I.I.I.D

Date: 25-09-2017	Drawing No.
Revision Date:	Sheet No. 06
	Scale NTS
	All Dimensions are in CMs.

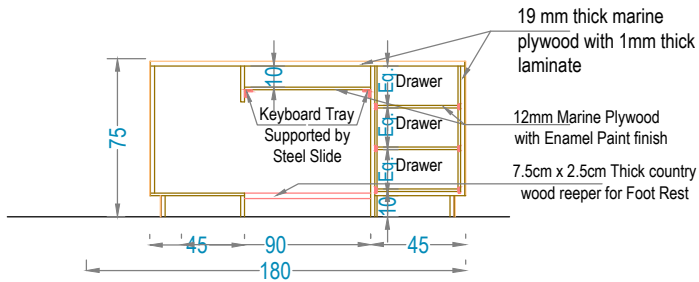

SECTION- AA

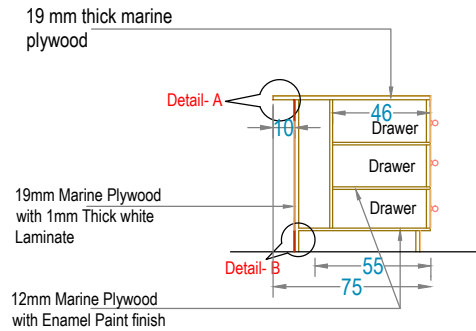

SECTION-BB

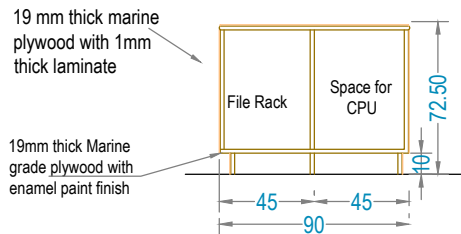

SECTION CC OF SIDE TABLE

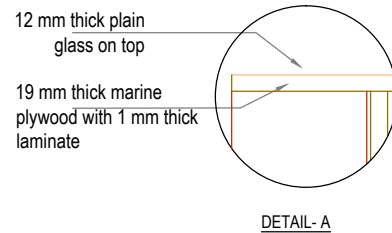

DETAIL- A

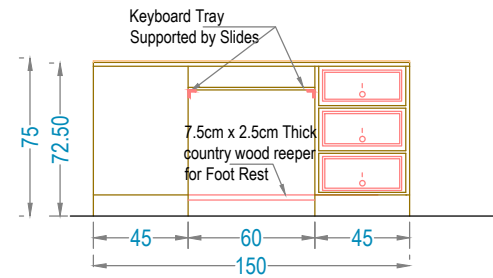

REAR ELEVATION OF TABLE

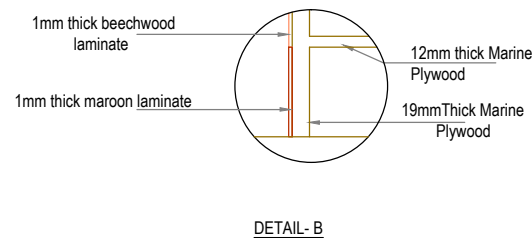

DETAIL- B

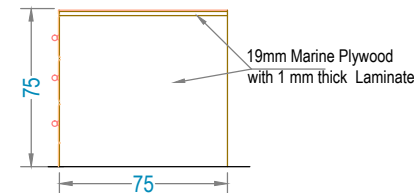

SIDE ELEVATION OF TABLE

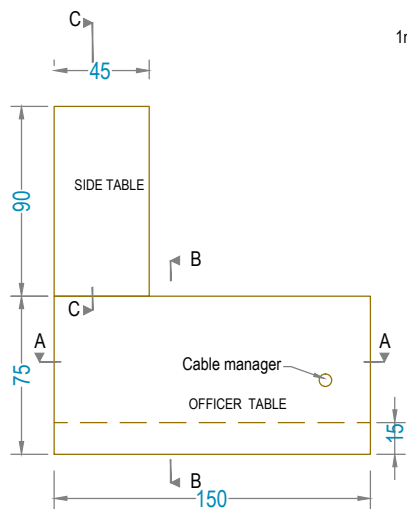

PLAN

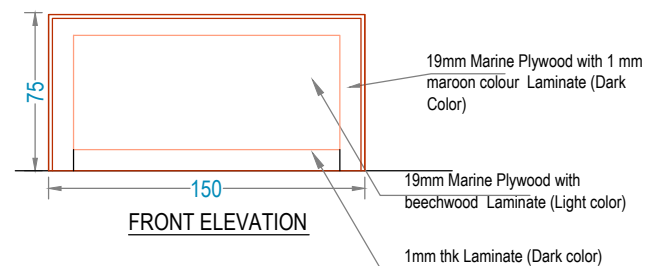

FRONT ELEVATION

**PROPOSED INTERIOR
 FURNISHING FOR UNITED
 INDIA INSURANCE
 CORPORATION - NENMARA**

DETAILS OF :	ITEM NOS.
1. OFFICER TABLE 150X75X75	09
2. SIDE TABLE 100X45X72.5	14

Drawn by	DISMI DAVIS
Architect	PRAVEEN.P B. Arch.[Reg], A.I.I.A, A.I.I.I.D
Structural Consultant	Dr. R.P.R. NAIR M.Tech.(Stru) Ph.D., F.I.E., M.ISTE, M.I.CI, M.CSI, C. Eng.(I).
Managing Partner	Ar. K. RAMAKRISHNAN B.Sc.(Engg), F.I.E, C. Eng (I), F.I.V , F.I.I.A. (Regd), A.I.I.I.D

Date: 25-09-2017	Drawing No.
Revision Date:	Sheet No. 06
	Scale NTS
	All Dimensions are in CMs.

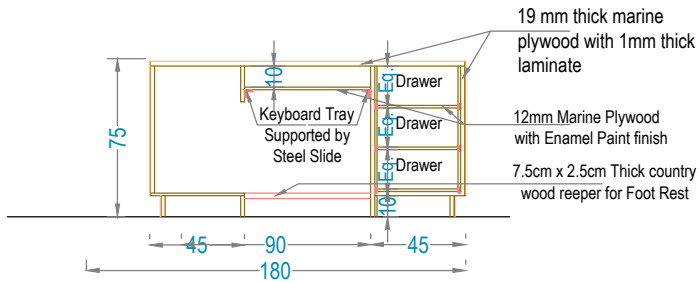

SECTION- AA

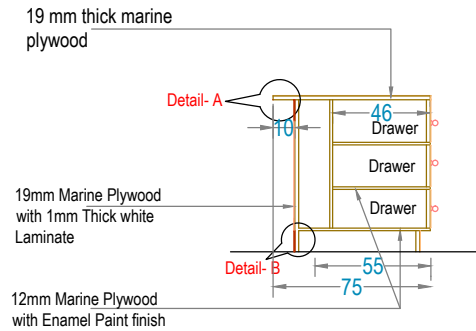

SECTION-BB

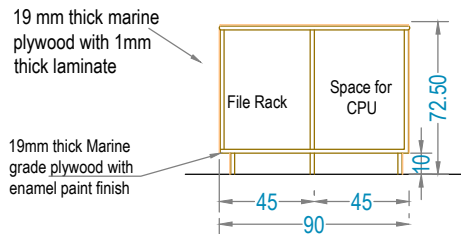

SECTION CC OF SIDE TABLE

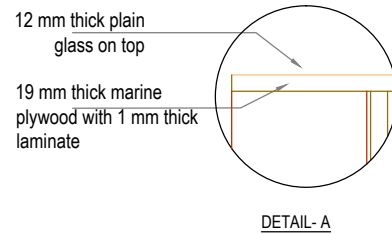

DETAIL- A

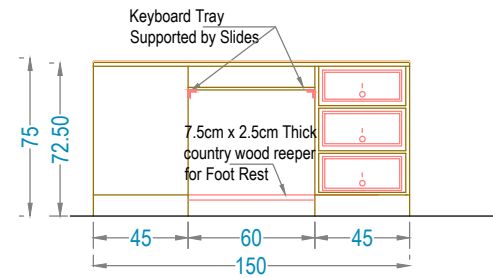

REAR ELEVATION OF TABLE

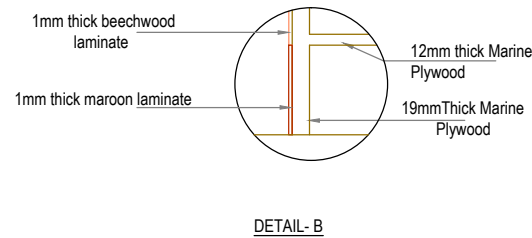

DETAIL- B

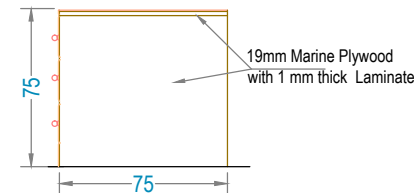

SIDE ELEVATION OF TABLE

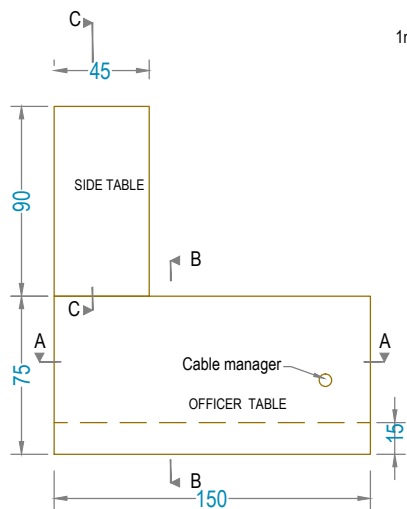

PLAN

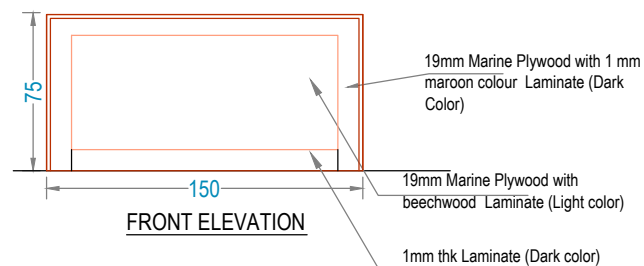

FRONT ELEVATION

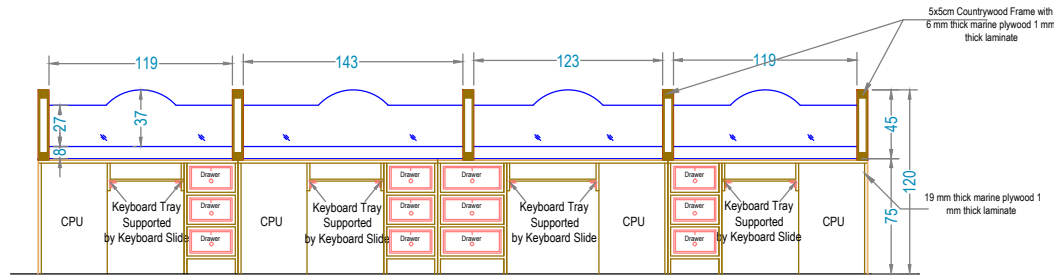

SECTION BB

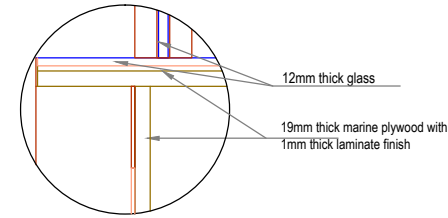

DETAIL-A

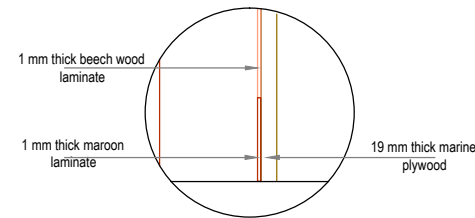

DETAIL-B

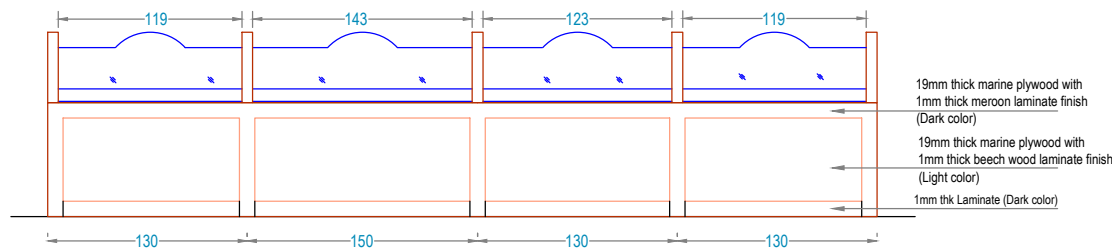

FRONT ELEVATION

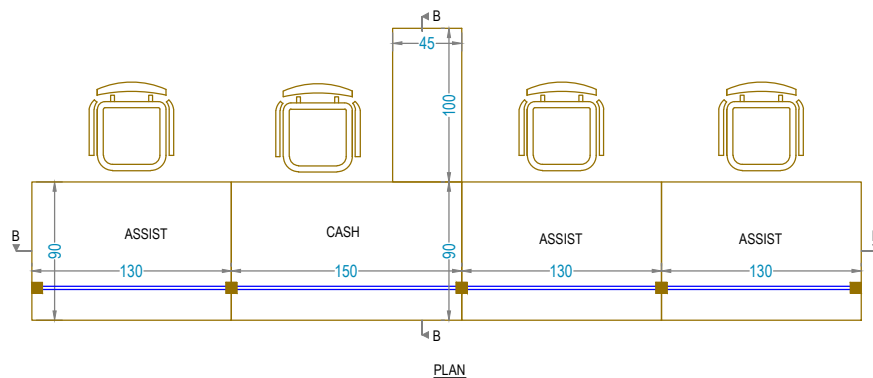

PLAN

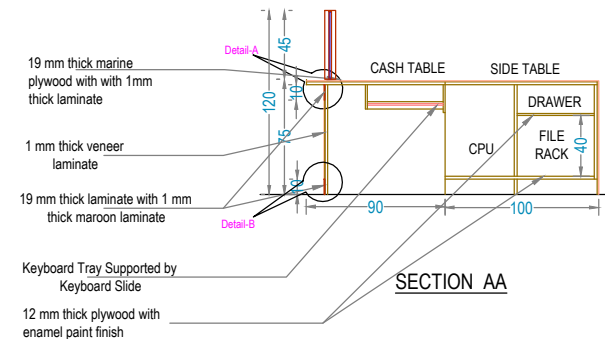

SECTION AA

**PROPOSED INTERIOR
 FURNISHING FOR UNITED
 INDIA INSURANCE
 CORPORATION - NENMARA**

DETAILS OF :	ITEM NOS.
1. COUNTER PARTITION	03
2. SIDE TABLE 100 X 45 X 72.5 CM	14
3. CASH OFFICER TABLE 150 X 90 X 75 CM	11
4. ASSISTANT TABLE 130 X 90 X 75 CM	12

Drawn by	DISMI DAVIS
Architect	PRAVEEN.P B. Arch.[Reg], A.I.I.A, A.I.I.I.D
Structural Consultant	Dr. R.P.R. NAIR M.Tech.(Stru) Ph.D., F.I.E., M.ISTE, M.I.CI, M.CSI, C. Eng.(I).
Managing Partner	Ar. K. RAMAKRISHNAN B.Sc.(Engg), F.I.E, C. Eng (I), F.I.V, F.I.I.A. (Regd), A.I.I.I.D

Date: 25-09-2017	Drawing No.
Revision Date:	Sheet No. 08
	Scale NTS
All Dimensions are in CMs.	



ENARC CONSULTANTS
ARCHITECTS & ENGINEERS
 M. G. Road, Thrissur - 1.
 Tel. : (+91 487) 2441901
 Fax : (+91 487) 2442011
 E-mail : office@enarc.net.in

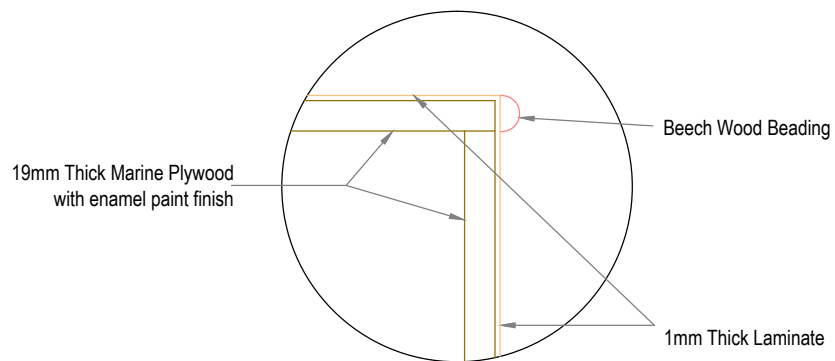

DETAIL-A

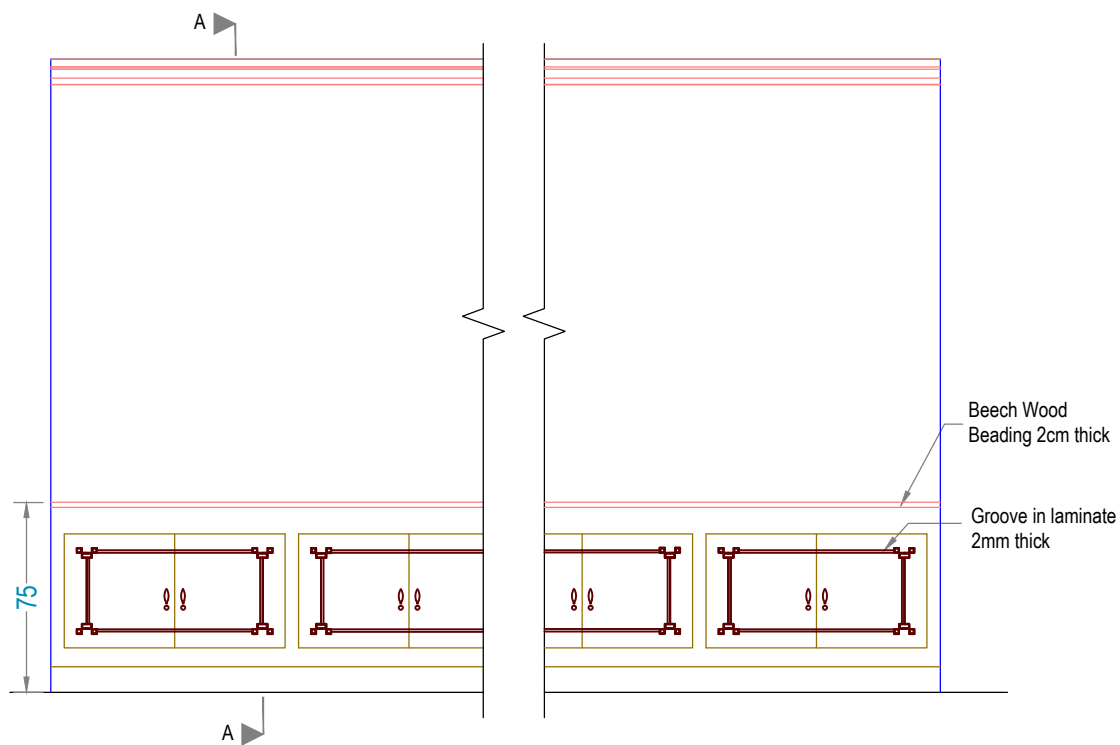

ELEVATION

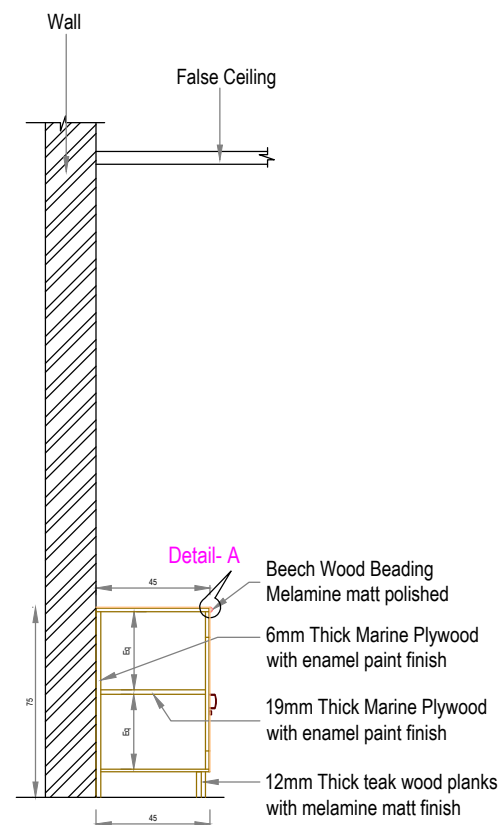

SECTION-AA

**PROPOSED INTERIOR FURNISHING
 FOR UNITED INDIA INSURANCE
 CORPORATION - NENMARA**

DETAILS OF :	ITEM NOS.
LOW LEVEL CUPBOARDS - 75CM HEIGHT	6a

Drawn by	DISMI DAVIS
Architect	PRAVEEN.P B. Arch,[Regd], A.I.I.A, A.I.I.I.D
Structural Consultant	Dr. R. P. R. NAIR, M. Tech.(Stru.) Ph.D., M.I.E, M.I.S.T.E., C.Eng(I)
Chief Architect	Ar. K. RAMAKRISHNAN B.Sc.(Engg), M.I.E, C. Eng (I), F.I.V, F.I.I.A. (Regd), A.I.I.I.D

Date: 25-09-2017	Drawing No.
Revision Date:	Sheet No: 09
	Scale NTS
All Dimensions are in CMs.	